

## Rocky View County Family & Community Support Services (FCSS)

# 2022 FCSS SPECIAL PROJECTS FUNDING APPLICATION (FUNDING PERIOD: JANUARY 1 – DECEMBER 31, 2022)

Please type or print legibly. Applicants must be a non-profit organization/agency that serves Rocky View County residents. ***Please note that faxed or e-mailed copies of the application will not be accepted. It is strongly recommended that you courier or hand deliver your proposal (printed single sided pages only) and request confirmation of receipt. APPLICATION DEADLINE IS 4:00 P.M. AUGUST 30, 2021 - APPLICATIONS NOT RECEIVED BY THIS DEADLINE WILL NOT BE ACCEPTED.***

1. ORGANIZATION INFORMATION	
Organization Name	Friends of Spirit Winds Ranch Society
Project Name	Equine Assisted Learning for families and community wellness
FCSS Funding Request (Maximum \$7,500) (from Section 9.6 C Proposed Budget)	\$7500.00
E-Mail Address and Website	laurel@spiritwindsranch.ca / spiritwindsranch.ca
Mailing Address (include postal code)	Box 474 Cochrane Alberta Canada T4C-1A7
Street Address (for courier purposes)	54101 Twp Road 270
Agency Telephone Number	403-999-7763
Agency Fax Number	/
Executive Director Name	n/a
Program Contact Name	Holly Strand / hair, Board of Directors
Phone Number (If different from above)	

☐ Please email confirmation of receipt of this application to: [Click here to enter text.](#)

2. PREVENTION		
In what way(s) is your program preventive in nature? Check the appropriate items from the following list. You will be required to report on each of the Outcomes that you have selected.		
Provincial Outcome	Rocky View County Outcomes	
Improved social well-being of individuals	Outcome 1: Individuals experience personal well-being. Indicators: Resilience; self-esteem; optimism; capacity to meet needs; autonomy; competence; personal engagement; meaning and purpose.	☑
	Outcome 2: Individuals are connected with others. Indicators: Quality of social relationships; social supports available; trust and belonging.	☑
	Outcome 3: Children and youth develop positively. Indicators: Developmental assets.	☑

Provincial Outcome	Rocky View County Outcomes	
Improved social well-being of families	Outcome 4: Healthy functioning families. Indicators: Positive family relationships; positive parenting; positive family communications.	☑
	Outcome 5: Families have social supports. Indicators: Extent and quality of social networks; family accesses resources as needed.	☑

Provincial Outcome	Rocky View County Outcomes	
	Outcome 6: The community is connected and engaged.  Indicators: Social engagement; social support; awareness of the community; positive attitudes toward others and the community.	<input checked="" type="checkbox"/>
Improved social well-being of the community.	Outcome 7: Community social issues are identified and addressed.  Indicators: Awareness of community social issues; understanding of community social issues; agencies and/or community members work in partnership to address social issues in the community.	<input checked="" type="checkbox"/>

### 3. PROJECT DESCRIPTION

Attach a separate page providing a brief overview of your organization and the project.

- a) Describe briefly how this is a special project and how it will specifically support Rocky View County Residents. Rocky View County residents do not include people who reside in Airdrie, Beiseker, Chestermere, Cochrane, Crossfield, Irricana or Redwood Meadows. It does include those who live outside of these municipalities and within the hamlets located within the County's borders.
- b) Define your region of operation;
- c) Include the statement of need;
- d) The activities that will be used to address the need;
- e) The expected outcomes; and
- f) Agency/project mission. What is your mission and what are you currently doing to achieve your mission (e.g. other programs and services that are not a part of this application for funding)?

### 4. PROJECT FIGURES

- a) Estimated Number of Total Program Participants: [Click here to enter text.](#)
- b) Estimated Number of County Resident Program Participants: [Click here to enter text.](#)
- c) Estimated Number of Volunteer Hours Related to Program: [Click here to enter text.](#)

### 5. SUPPORTING DOCUMENTS

The following documents **must** be attached:

- a) Organization's Annual Financial Statement;
- b) Organization's Proposed Operating Budget – include contributions from other sources and detailed expenditures, do not include in-kind supports, only actual dollars. A budget shell is attached on the next page if you wish to use it;
- c) List of Organization's Officers and Directors. Do not include personal contact information (home addresses, emails, or phone numbers);
- d) A copy of Alberta Societies Act Registration if new applicant.

Other documents may also be attached to the application form that provides further clarification.

### 6. CERTIFICATION OF COMPLIANCE:

**This is to certify that to the best of my knowledge and belief, the information included in this application complies with the requirements and conditions set out in the Family and Community Support Services Act and Regulation. (<https://www.alberta.ca/family-and-community-support-services-fcss-program.aspx>)**

**A project outcomes evaluation is required by February 28, 2023 if your application is successful.**

  
(Signature of Applicant)

CHAIRPERSON  
(Print Name & Title)

AUG. 27, 2021  
(Date)

### 3. PROJECT DESCRIPTION

a) The Friends of Spirit Winds Ranch Society is comprised of a volunteer board of directors who are committed to supporting individuals and families via the delivery of E.A.L. Equine Assisted Learning Programs

Society supported programs offer opportunities to explore and develop both life skills and relationship building skills through equine communication in a safe, inclusive environment

b) See attached map

c) Families and individuals in Rocky View County are facing unprecedented life challenges. The current economy and health related issues have resulted in many families and individuals facing social isolation and limited program availability in a safe and inclusive environment. Programing has been expanded to various groups. I

d) Equine Assisted Learning Programs focus on using horses to deliver a series od programs and workshops. Individuals and families learn effective communication and collaboration skills by means of interacting with other program participants and equine teachers to solve a series of enjoyable and often challenging problems. E.A.L. is proven by University of Calgary studies to be an effective retentive approach in human development that encourages both individual and family growth

e) E.A.L. programs have been observed by teaching professionals in Rocky View County over the past 4 years. The feed back received from school principals, psychologists, guidance counselors and teachers has been overwhelming and encouraging with respect to positive behavioural change in participants.

f) The mission of friends of Spirit Winds Ranch Society is to provide;

opportunities for individuals and families in need to build a life and relationship skills through interactions within small groups and a 1200 lb horse, facilitated by qualified E.A.L. instructors in a safe environment

We have adjusted out programming to accommodate seniors, mentally and physically challenged individuals.

Please indicate how you heard of the Rocky View County FCSS Program:

☐ newspaper ad     
 ☒ social media     
 ☒ website visit/search  
☐ word of mouth     
 ☐ other (specify) \_\_\_\_\_

Submit Completed Documents to:

Dimitri Dimopoulos, FCSS Coordinator  
 Rocky View County  
 262075 Rocky View Point  
 Rocky View County, AB T4A 0X2

**For further assistance, please call 403.520.1289**  
**or email fcss@rockyview.ca**

***The FCSS Program Is Not:***

- Recreational.
- A Public Health Transportation Grant.
- Direct assistance, including money, food, clothing or shelter to sustain an individual or family.
- Rehabilitative.
- A duplication of services from other Government Agencies.

***\*ALL INFORMATION PROVIDED IS PUBLIC\****

*The personal information on this form is being collected for the purpose of determining eligibility of an applicant to receive FCSS funding; to assist in administering the FCSS funding; and to monitor, assess, and evaluate your program. This information is collected under the authority of Section 33 (c) of the Freedom of Information and Protection of Privacy Act and may become public information once it is submitted to the FCSS program. Questions regarding the collection of this information can be directed to the Manager, Recreation, Parks and Community Support at 403.520.6307.*

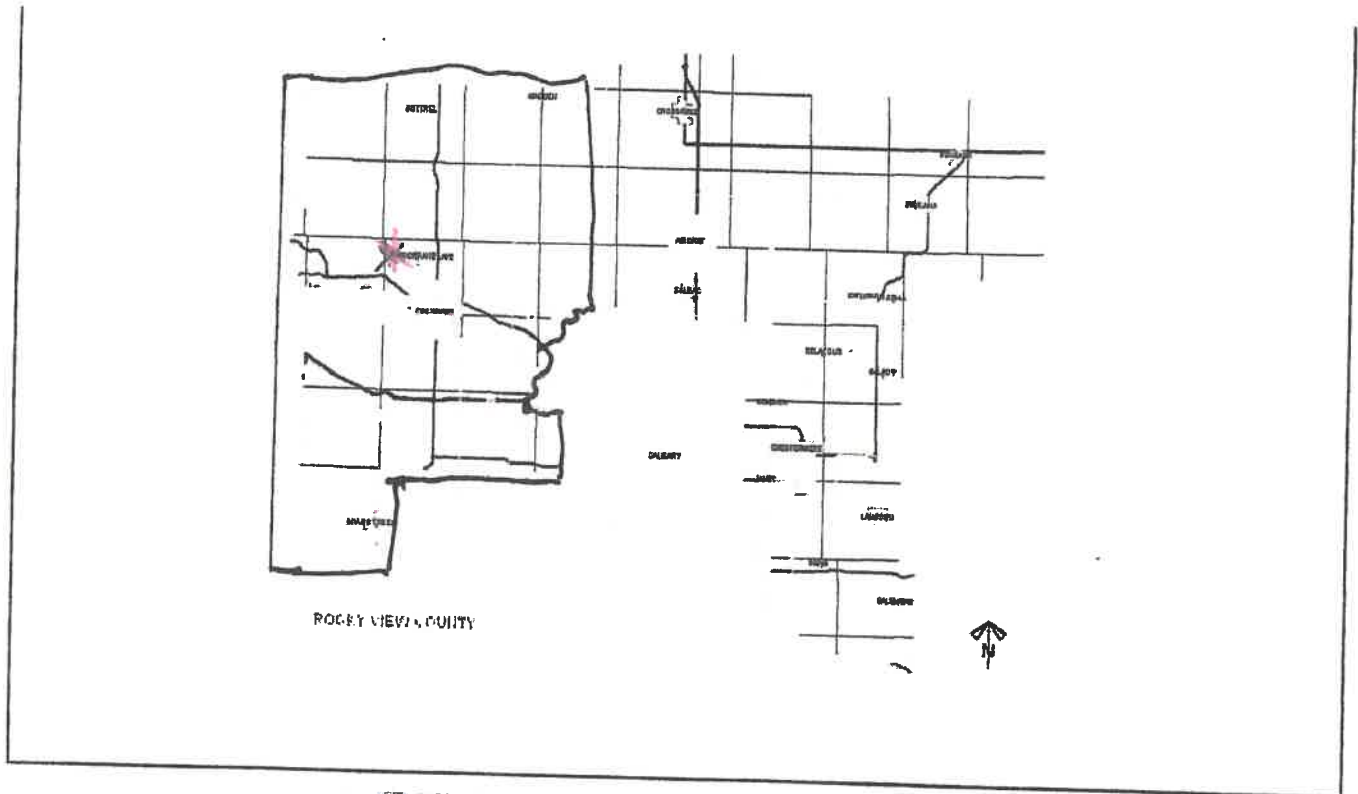

**9.6 C. INPUTS** (Resources dedicated to the program. Include staff and budget for one year.)

**2022 PROPOSED BUDGET** (Ensure all calculations are correct. Use the second column to itemize the program expenses to which you plan to direct the County FCSS funds. Column 1 + Column 2 = Column 3)

ITEM	Column 1 2022 Costs to be paid or contributed by the Applicant and other funding partners (Agency Contribution)	Column 2 2022 Costs to be funded by County FCSS (Program Request)	Column 3 2022 Projected Year End Total Program Budget (Total Cost)
<b>EXPENSES</b>			
<b>PERSONNEL</b> (specify positions and hours per week)			
FACILITATORS			
(45.00 HR. X 18 HRS.			
PER SESSION X 3			
X 2 FACILITATORS		4,860.00	
a. SUBTOTAL PERSONNEL		4,860.00	4,860.00
<b>TRAVEL &amp; TRAINING</b> (specify)			
INSURANCE	1150.00	1150.00	
VAN MAINTANANCE			
(GAS, OIL, ETC.)		500.00	
b. SUBTOTAL TRAVEL & TRAINING	1150.00	1,650.00	2,800.00
<b>MATERIALS AND SUPPLIES</b> (specify)			
PROGRAM, PARTICIPANT			
INCLUDING P.P.E.	500.00	990.00	
c. SUBTOTAL MATERIALS AND SUPPLIES	500.00	990.00	1490.00
<b>OTHER</b> (specify)			
MARKETING	300.00		
d. SUBTOTAL OTHER	300.00		300.00
e. TOTAL EXPENDITURES (e=a+b+c+d)	1950.00	7500.00	9,450.00
<b>REVENUE</b> (specify other sources of funding including fundraising, fees for service, other grants, etc.)			
ROCKYVIEW COUNTY	7,500.00		
GRANTS & DONATIONS	1,950.00		
f. TOTAL REVENUE	9,450.00		
g. FCSS REQUEST (DEFICIT = Total of Column 3 Expenditures - Total Revenue)			



Microsoft Excel  
Worksheet

**Friends of Spirit Winds Ranch Society - Finance Summery as of Dec 31, 2020**

Opening Bank Balance (January 1, 2020): \$7,929.00

**Summary of Income:**(Revenues)

Grants Received \$9500.00

Donations \$705.50

**Total:** \$10,205.50

**Summery of Expenses:**

Transportation \$1,911.05

Marketing \$262.50

Capital (Infrastructure) \$3,797.75

Insurance \$760.00

Bank Fees \$4.00

Program Facilitors, program supplies, \$7586.00

(including all Covid related P.P.E.)

**Total:** \$14,321.30

**Bank Balance as of December 31, 2020** \$3,813.49

**\*Note 1 :** The above financial statement dose not reflect all in kind donations of services and materials.

Holly Strand

A handwritten signature in black ink, appearing to read 'Holly Strand', is written over a horizontal line.

**Friends of Spirit Winds Ranch Board of Directors 2020**

<b>NAME</b>	<b>POSITION</b>
Holly Strand	Chair
Deryck Jones	Vice-Chair
Dawn Mercer	Treasurer
Norma Jones	Secretary
Brenda Budgell	Communications/Marketing
Dr. Suzy Nadeau	Member at Large - Veterinarian
Lynn Norbury	Member at Large
Laurel Griffin	Advisor



**CORPORATE ACCESS NUMBER: 5021585632**

**Government  
of Alberta ■**

**SOCIETIES ACT**

**CERTIFICATE  
OF  
INCORPORATION**

**FRIENDS OF SPIRIT WINDS RANCH SOCIETY  
WAS INCORPORATED IN ALBERTA ON 2018/11/26.**





Box 1544, Cochrane, AB, T4C 1B5  
[www.bighillhaven.com](http://www.bighillhaven.com)

May 14, 2021

To Whom It May Concern:

Dear Sir or Madam;

Please accept this letter as an indication of our strong support of Laurel Griffin and the amazing work she does with youth and their parents at Spirit Winds Ranch. Clients of Big Hill Haven have had the experience of visiting the Ranch and participating in her Facilitated Equine Assisted Learning program.

Big Hill Haven provides Emergency Shelter and Outreach Support for women and their children who are escaping or experiencing family violence. We are very protective of our clients and carefully vet any organizations who will be working with these vulnerable families. Having said that, Ms. Griffin was kind enough to invite me and my 8-year-old grandson to visit the Ranch and go through the program exactly as a client would. I can say without hesitation that it was a wonderful experience. Ms. Griffin was respectful, kind, wise and answered all of our questions in a thoughtful manner which taught us so much more than we ever expected to learn. To this day, my grandson still speaks of her and her horses fondly.

We were able to refer two of our Moms and their children to the program and each of them cannot say enough good things about their experience. One of the Moms attended with her own mother and her daughter and they previously had a great deal of conflict in their family. They each reported after one lesson much less tension and improved relationships with each other. When the opportunity arose for them to return for a second lesson, all three were incredibly excited. The second session taught them even more about respectful, healthy communication and their own individual strengths. From having worked with this family, I can say that their challenges were many and their family situation had not been a comfortable one. But after two sessions with Ms. Griffin, I observed a significant improvement.

The second family had the same positive experience and spoke very highly of Ms. Griffin's leadership.

I had the opportunity to carefully observe Ms. Griffin's interactions with my grandson, how she was able to guide him in his interactions with his horse; he responded extremely well and I saw his body language and demeanor become more relaxed as the lesson progressed. This boy comes from an abusive home and he faces many of the same challenges as do our young clients who come to us with their mothers. Having seen the loving way Ms. Griffin answered his questions and guided him through the experience, I have no hesitation in recommending her and her program to anyone who has youth for her to help.



Box 1544, Cochrane, AB, T4C 1B5  
[www.bighillhaven.com](http://www.bighillhaven.com)

Please do not hesitate to contact me should you require any further information or if you have any questions I may answer. Big Hill Haven feels very fortunate to have had this opportunity for our clients and their children and I know that any other families and/or youth will benefit from this program in countless ways.

Best Regards,

Patti Fisher

Patti Fisher

Co-Founder and Program Manager

Big Hill Haven

403-796-6564

[bighilloutreach@gmail.com](mailto:bighilloutreach@gmail.com)

Box 1544, Cochrane, AB

T4C1B5



Principal: Christine Parker, Assistant Principal: Hana Hooper

To whom it may concern,

November 15, 2018

This letter is in regards to the Equine Assisted Learning (EAL) that has been offered to our school from Spirit Winds Horse Center. Our first time involved with this program was in the spring of 2018 and at that time, we had 12 students who participated in this program. Presently Westbrook School has 16 students, from grade 3 to grade 8, involved in a 6 week program. Our first group has their class from 10:00-11:00 am and the second group goes from 12:00-1:00pm.

This program is a unique way of learning using horses to help students learn about themselves and others by working closely with the horses and then having to process (discussing) feelings, behaviors, and patterns. EAL has a focus on trying to meet educational goals through setting up ground activities with the use of a horse to apply skills for personal growth, development, learning to trust, working on problem-solving skills and being mindful on your own body language.

Students are very excited and look forward to their Wednesday Equine sessions. It appears working with a horse is a very effective and powerful approach to helping individual development that encourages individual and team growth. The students comment they are engaging in fun, creative and meaningful exercises that helps them learn value life skills. The students learn the importance of having good listening skills and observation skills, as they need to pay close attention to the body language the horse may be trying to communicate to them. These awareness skills help students move forward in their learning within the program but also in their personal lives.

I am hoping and looking forward to many more students at Westbrook School to have an opportunity to participate in the Equine Assisted Learning. Through my own life experiences of growing up with horses, I know how much an individual can learn about themselves as they work along beside these beautiful, big, powerful and intuitive animals. I have received many positive comments from students and parents on how much they appreciated this great program while in school. These social programs are a great opportunity for students to cooperate and appreciate the knowledge and wisdom that they can obtain from interacting with others. I have personally witnessed some students who have improved in their peer relations, self-esteem, learned how to make better choices and learned to be more empathetic towards others.

As a staff member at Westbrook School, we value these outside programs and would like them to continue to grow and be offered to the students in the Cochrane and surrounding area.

Sincerely,  
Jona Kondrat  
Child Development Advisor  
Westbrook School  
403-932-5443



**Interactivity** of mind, body and spirit.

With a 1200 pound teacher... **Makes all the difference!**

One of the many benefits of working with horses, rather than in a classroom setting, is the component of interactivity. Since we all learn differently, interactive learning enables everyone to learn lessons and skills through experiences. The healing power of horses is felt through the relationships we build with them. Through equine connection we engage the body, mind and spirit by providing fun, innovative and immediate result-orientated programs with specific objectives.

# Equine Assisted Learning



## YOUTH PROGRAMS INCLUDE

A customized curriculum  
Nationally certified program  
Our venue and facilitators  
Insurance  
Handouts for each program  
A Facilitator's account of each program  
A participant's account of their experience  
Classroom debriefing  
Healthy snacks and water

## Horses Teaching Humans YOUTH PROGRAMS

- ★ challenging games
- ★ fun and engaging
- ★ interactive
- ★ thought provoking
- ★ life changing

FB

@friendsofspiritwindsranch

IG

@spiritwindsranch



Ranch Owner and Facilitator

**LAUREL GRIFFIN**

## Why does our program work & what sets us apart?

All of our exercises are custom designed to maximize learning potential and focus on developing individual skills while working through each unique interactive group challenge. Teams work together to develop relationships and overcome barriers while being encouraged to be creative and think outside the box.

Individuals realize the benefits associated with effective communication while recognizing the value of teamwork, mutual trust and respect.

*All this, while experiencing a new, wonderful environment and having a blast!*



## BENEFITS FOR YOUTH

Participants are taught how to change their perspective on social interaction and coordination while learning essential skills such as:

**Teamwork ★ Leadership ★ Empathy ★ Communication**



### THERE IS NOTHING LIKE A 1200 LB TEACHER

By their very intuitive and innate sensitivity, horses can provide facilitators with a window into a participant's personality. Horses mirror the feelings of the participants, which encourages them to adjust their feelings and behaviours in order to work successfully with the horses.

- Step outside the classroom and learn through hands on experience
- Our senior horses are given a new purpose in life
- A horse gives feedback that is honest and instant
- Horses consistently model assertiveness and teach us how to do the same
- Nature provides horses with instinct and astute senses
- Horses help to instill empathy and kindness naturally

