



BYLAW C-8113-2020

A Bylaw of Rocky View County, in the Province of Alberta, to amend Rocky View County Bylaw C-8000-2020, being the *Land Use Bylaw*

The Council of Rocky View County enacts as follows:

Title

1. This Bylaw may be cited as *Bylaw C-8113-2020*.

Definitions

2. Words in this Bylaw have the same meaning as those set out in the *Municipal Government Act* except for the definitions provided below:
 - (1) “**Council**” means the duly elected Council of Rocky View County;
 - (2) “**Land Use Bylaw**” means Rocky View County Bylaw C-8000-2020, being the *Land Use Bylaw*, as amended or replaced from time to time;
 - (3) “**Municipal Government Act**” means the *Municipal Government Act*, RSA 2000, c M-26, as amended or replaced from time to time; and
 - (4) “**Rocky View County**” means Rocky View County as a municipal corporation and the geographical area within its jurisdictional boundaries, as the context requires.

Effect

3. THAT Schedule B, Land Use Map, of C-8000-2020 be amended by redesignating a portion of SE-22-28-05-W05M from Agricultural, General District (A-GEN) to ~~Residential, Rural District (R-RUR)~~ and Agricultural, Small Parcel District (A-SML p8.1), as shown on the attached Schedule 'A' forming part of this Bylaw.
4. THAT a portion of SE-22-28-05-W05M is hereby redesignated to ~~Residential, Rural District (R-RUR)~~ and Agricultural, Small Parcel District (A-SML p8.1), as shown on the attached Schedule 'A' forming part of this Bylaw.

Effective Date

5. Bylaw C-8113-2020 is passed and comes into full force and effect when it receives third reading and is signed in accordance with the *Municipal Government Act*.



ROCKY VIEW COUNTY

READ A FIRST TIME this 22nd day of December, 2020

PUBLIC HEARING HELD this _____ day of _____, 2021

READ A SECOND TIME this _____ day of _____, 2021

READ A THIRD AND FINAL TIME this _____ day of _____, 2021

Reeve

Chief Administrative Officer or Designate

Date Bylaw Signed

22

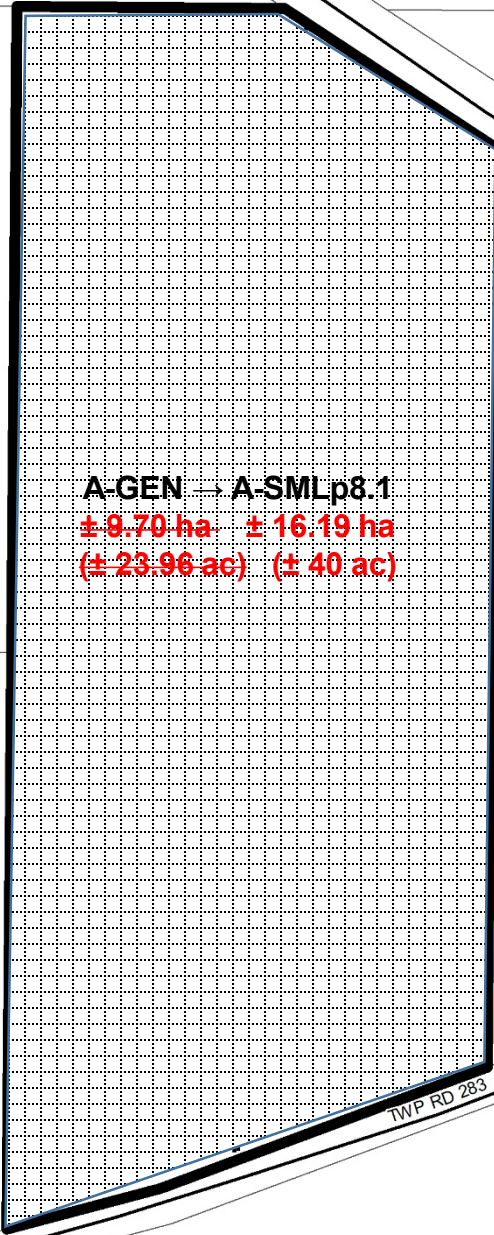



A-GEN → A-SMLp8.1
~~± 9.70 ha ± 16.19 ha~~
~~(± 23.96 ac) (± 40 ac)~~

Schedule 'A'

Bylaw
C-8113-2020

Amendment

FROM
 Agricultural, General District
 (A-GEN) 

TO
 Residential, Rural District
 (R-RUR) 

FROM
 Agricultural, General District
 (A-GEN) 

TO
 Agricultural, Small Parcel
 District (A-SML p8.1) 

Division: 9
 Roll: 08922009
 File: PL20200104
 Legal: A Portion of SE-22-
 28-05-W05M

