



KALiNA
Clean. Energy.

Introducing Lone Pine Energy and Data Park

“Everybody is talking about the electricity constraints that are leading to difficulties in the [data centre] sector. Bring your own electricity, bring your own generation. Partner with a generating company.”

Alberta Premier Danielle Smith, on data centre siting in Alberta, July 12, 2024

**Natural Gas-Fired Power Generation
and Data Centre Development**

April 2025

KALiNA Distributed Power Limited (KDP)

At a Glance – Lone Pine Energy and Data Park

- KDP, in collaboration with a select DC Partner, proposes the development of the Lone Pine Energy and Data Park in Rocky View County Electoral Division 5
 - The project will span 320-acre parcel (E35-27-28 W4M)
- The development will be staged, deploying up to five “Energy-Data Centre Modules”
 - First Module energization (grid supply) is targeted for late 2027
- Each Energy-Data Centre Module will feature:
 - Up to 200 MW of natural gas-fired dispatchable electricity generation capacity plus 140-200 MW of data centre computing capacity
 - Approximately \$8 billion in capital expenditure
 - Significant local construction employment and 200 full-time permanent jobs in IT, operations, and maintenance
- Integrating gas-fired power generation capacity with each data centre module will:
 - Facilitate large-scale computing capacity development in Rocky View County and Alberta and Alberta
 - Align with Rocky View County’s economic development goals
 - Maintain Alberta’s electricity reliability and affordability

Lone Pine Energy and Data Park Development Vision

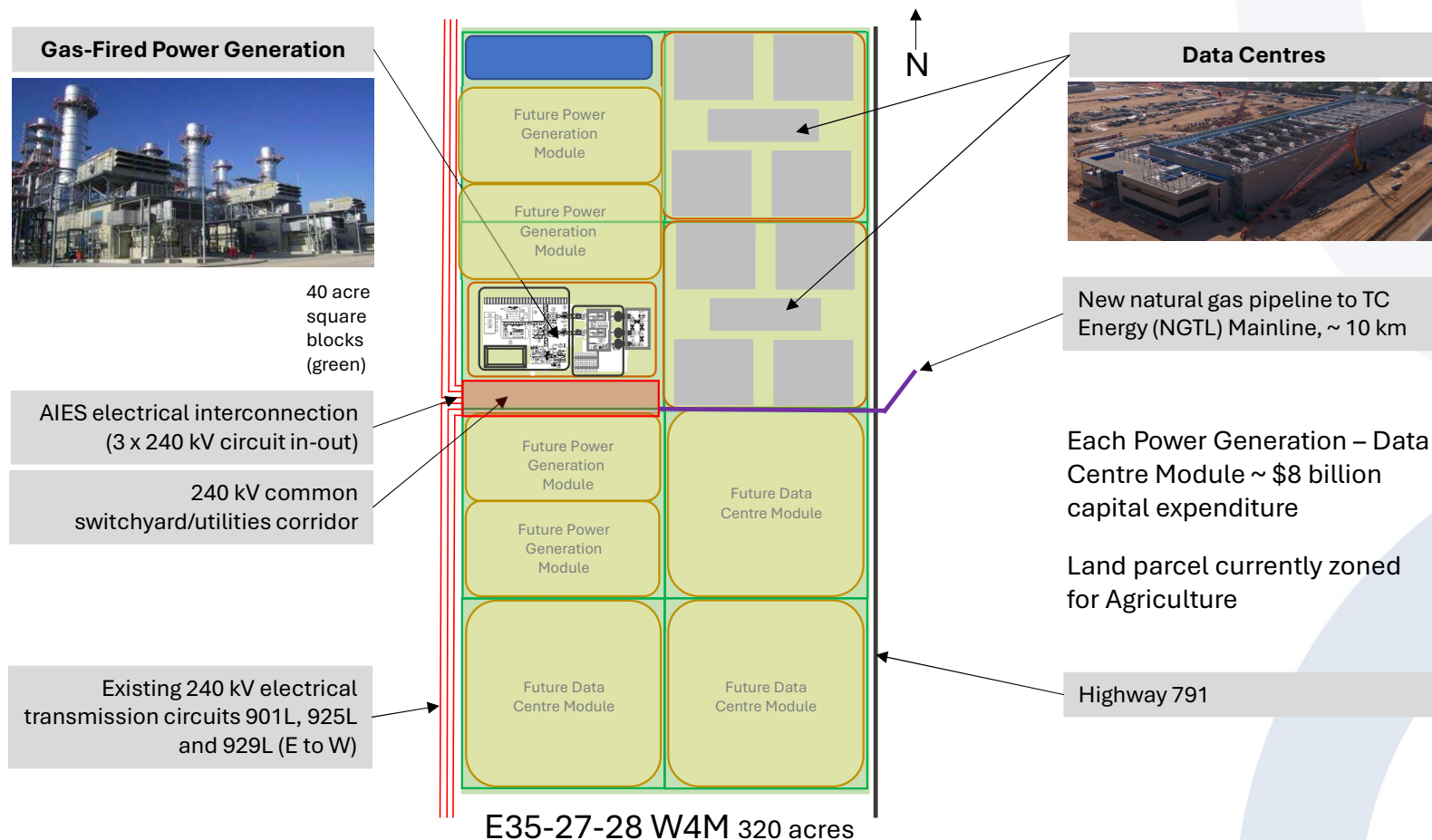

Lone Pine Energy and Data Park Sponsor

Capable Team Delivering Natural Gas-Fired Generation for Data Centres in Alberta

KALiNA Distributed Power

An Experienced Power Development Team

- Highly accomplished power development team and subject matter experts with proven track record of delivering projects on-time and within budget
- Team members have successfully delivered **over 20,000 MW** of power projects globally, including complex waste heat recovery, gas-fired peaking and cogeneration projects
- Have led over \$3 billion in transactions (M&A, project financing)
- Built Pristine Power Inc. with eventual sale to Veresen Inc. for \$118 million; several core Pristine members now with KDP
- Senior members of KDP have previously held C-suite and senior roles
- Along with an established network of partners and consultants, KDP's core competencies include site selection/acquisition, regulatory/environmental permitting, construction and contract management together with project financing

Lone Pine Energy and Data Park - Local Benefits

and Alignment with Rocky View County Development Goals

Local Benefit	
Economic Development per Energy-Data Centre Module (potential for 5 such Modules to be developed ultimately)	<ul style="list-style-type: none"> Investment of more than \$8 billion, >50% spent on local goods and services Over 6000 person-years construction employment Very material addition to County municipal tax asset base: ~ \$125 million capital investment per acre of developed site lands Over 200 operations/maintenance/technical permanent direct employment positions
Community Benefits	<ul style="list-style-type: none"> Attraction of other computing power-based businesses to the area to take advantage of data centre capacity – building a local technology ecosystem and value chain Minimal incremental municipal services demand – no new roads, water supplies, or wastewater services demand (self-contained)
Area Infrastructure Improvements	<ul style="list-style-type: none"> Enhanced fiber optic connectivity and communications infrastructure Gas-fired power generation dispatchable capacity protects and maintains Alberta electricity reliability and affordability

Excellent alignment with Rocky View County economic development goals:

- Investment Attraction
- Business Retention and Expansion
- Sector Development and Diversification
- Strengthen Economic Development Capacity

Location/Siting Rationale

Energy and Data Park Siting Factors

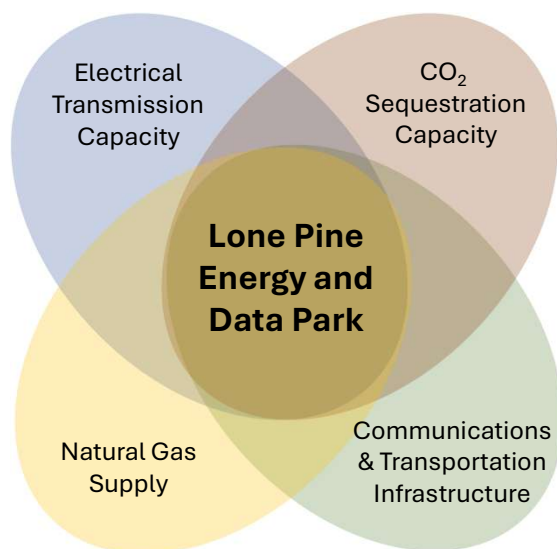

*Lone Pine Has All The Right Ingredients
for a Successful Energy and Data Park*

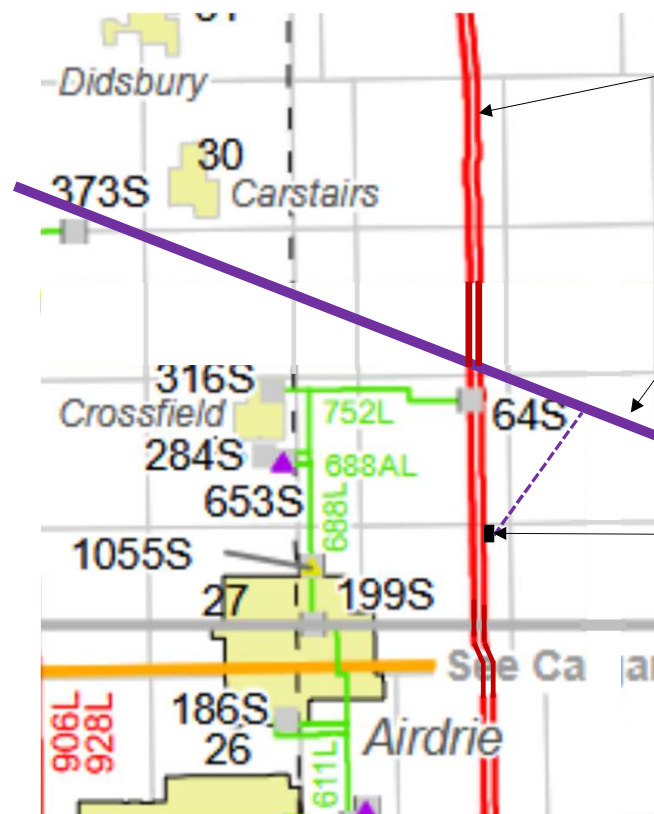

3 x 240 kV electrical transmission lines

TC Energy (NGTL) Mainline natural gas pipelines

Lone Pine Energy and Data Park
E35-27-28 W4M

Preliminary Development Schedule

		2025			2026				2027				2028				2029			
		2 Q	3 Q	4 Q	1 Q	2 Q	3 Q	4 Q	1 Q	2 Q	3 Q	4 Q	1 Q	2 Q	3 Q	4 Q	1 Q	2 Q	3 Q	4 Q
Module 1 – Power Project	Regulatory applications preparation and filing																			
	Rocky View County ASP/rezoning																			
	Consultation and engagement																			
	Pre-FEED stage engineering																			
	Processing/receipt of regulatory approvals																			
	FEED stage engineering/construction contracting																			
	Construction and commissioning																			
Electrical Interconnection	Development and AUC Approvals																			
	Construction and energization																			
Module 1 – Data Centre	Development and regulatory																			
	Consultation and engagement																			
	FEED Stage (engineering and approvals)																			
	Construction and commissioning																			

 Pre-FEED (Front-End Engineering Design) Stage

 FEED Stage

 Construction Stage

 Commercial Operations Stage

 FID Final Investment Decision



Lone Pine Energy and Data Park

Questions

KALiNA Distributed Power Limited (KDP)